

GP Component

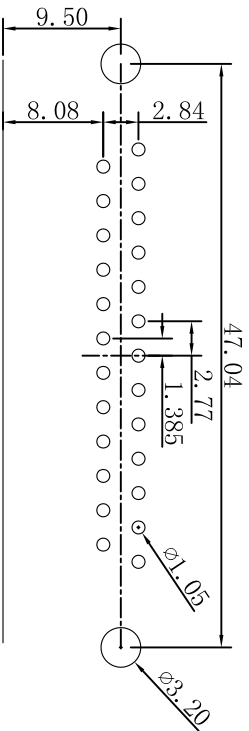

PCB layout

Specification Type (1:2)

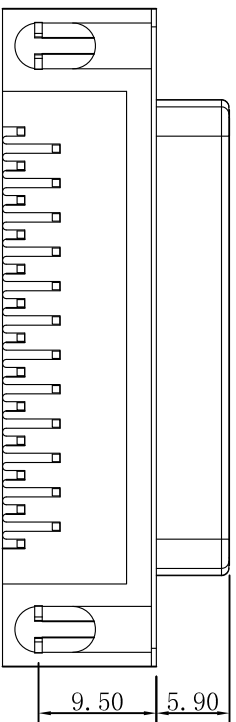
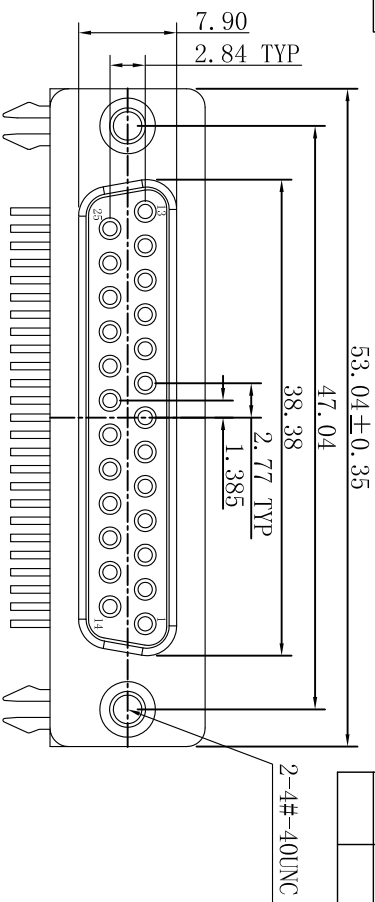
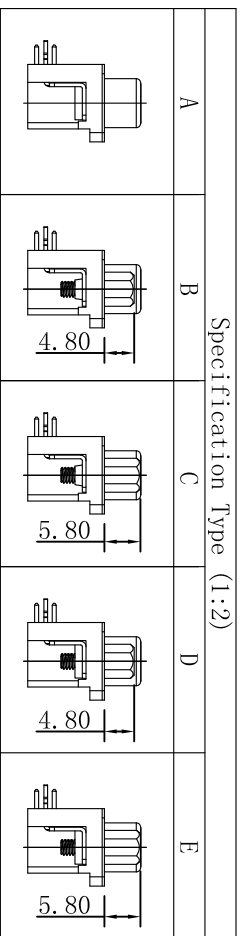

REV.	ECN NO.	LOCATIONS	DESCRIPTION	DATE	DESIGN
AO			原始版本(INITIAL EDITION)	2020.12.16	m t

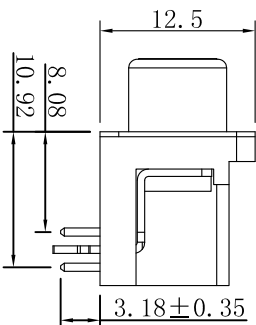

CHARACTERISTICS:

1. RATED VOLTAGE: 250V AC CD
2. RATED CURRENT: 3.0AMP
3. CONTACT RESISTANCE: 30mΩ Max.
4. INSULATION RESISTANCE: 1000 MΩ MIN. 500V DC
5. Electric Pressure: Keeping 60 second in AC 500V/1mA
6. Operating temperature: -55°C~105°C
7. INSERTION/EXTRACTION FORCE PER CONTACT: 8.5Kg Max
0.75Kg Min.

01.DR0825 F X XXX XX A XXX

PIN Poles	25:25PIN	M/F Differentiates	M=Male F=Female	Hsg Color	1=Black 3=Blue 2=White 4=Green 5=Yellow 6=Purple	Plating	G00:Gold flash G01:Gold 1U" G03:Gold 3U" Gxx:Gold XXU"	B00:Bright sn B01:Bright sn 1U" B03:Bright sn 3U" Bxx:Bright sn XXU"	M00:Matte sn M01:Matte sn 1U" M03:Matte sn 3U" Mxx:Matte sn XXU"	Water Code	Specification Type	Hsg Material

<p>东莞市跃展精密连接器有限公司 Dongguan YueZhan Precision Connectors Co., Ltd</p>	<p>UNIT: mm [inch]</p>	DESIGN: 牟 2020.12.16	PART NAME: DR 25F系列图
	TOLERANCE: X.X ±0.35 X.XX ±0.25 X.XXX ±0.15 Angle ±3.0°	CHECKED: 牟 2020.12.16	PART NO. 01.DR0825FXXXXXXXXXX
	APPROVED: 牟 2020.12.16	DRAW NO.	SHEET NO. 01 OF 01
	SCALE:1:1 SIZE:A4		